



artcobell

JOURNEY TO TRANSFORM LEARNING

TRANSFORM

LEARNING ENVIRONMENTS

TRANSFORM LEARNING

You're embarking on a journey.

And Artcobell is there to help you along the way. This guide links you to resources designed to make each stage a little easier.

Come along with us!

DREAM

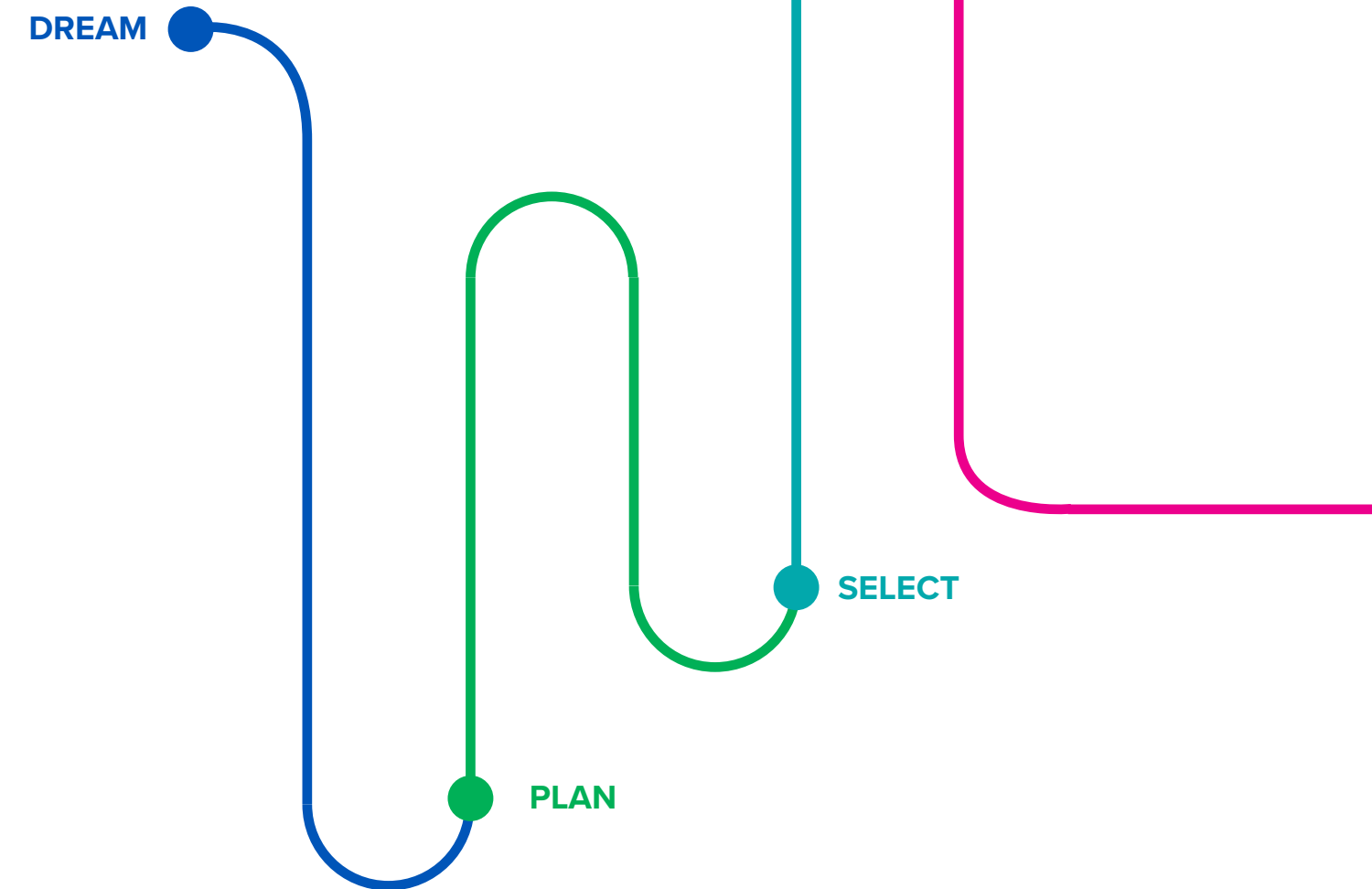

Dream

Define your “why”

American author, Simon Sinek, encourages us to clearly define our “why” before making any transformation. This guiding principle or purpose provides us with the framework we need to shape our thinking and actions, allowing us to be more innovative, more successful, and inspire others.

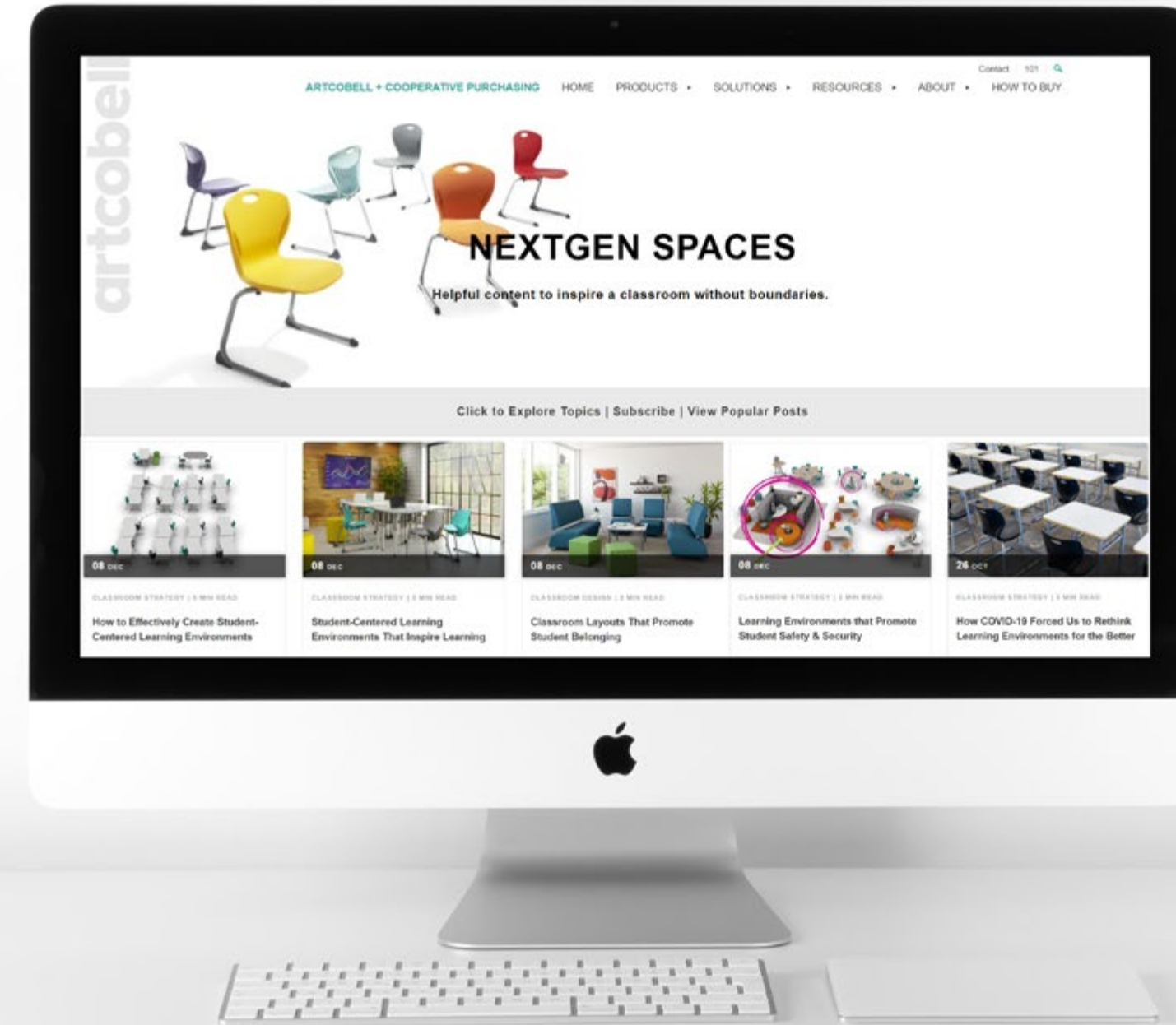

Website Tools:

NXTGEN Spaces
Blog



Image Gallery



Case Studies





eBook: Rethinking Classroom Learning Environments for the Future. Scan or click to download.

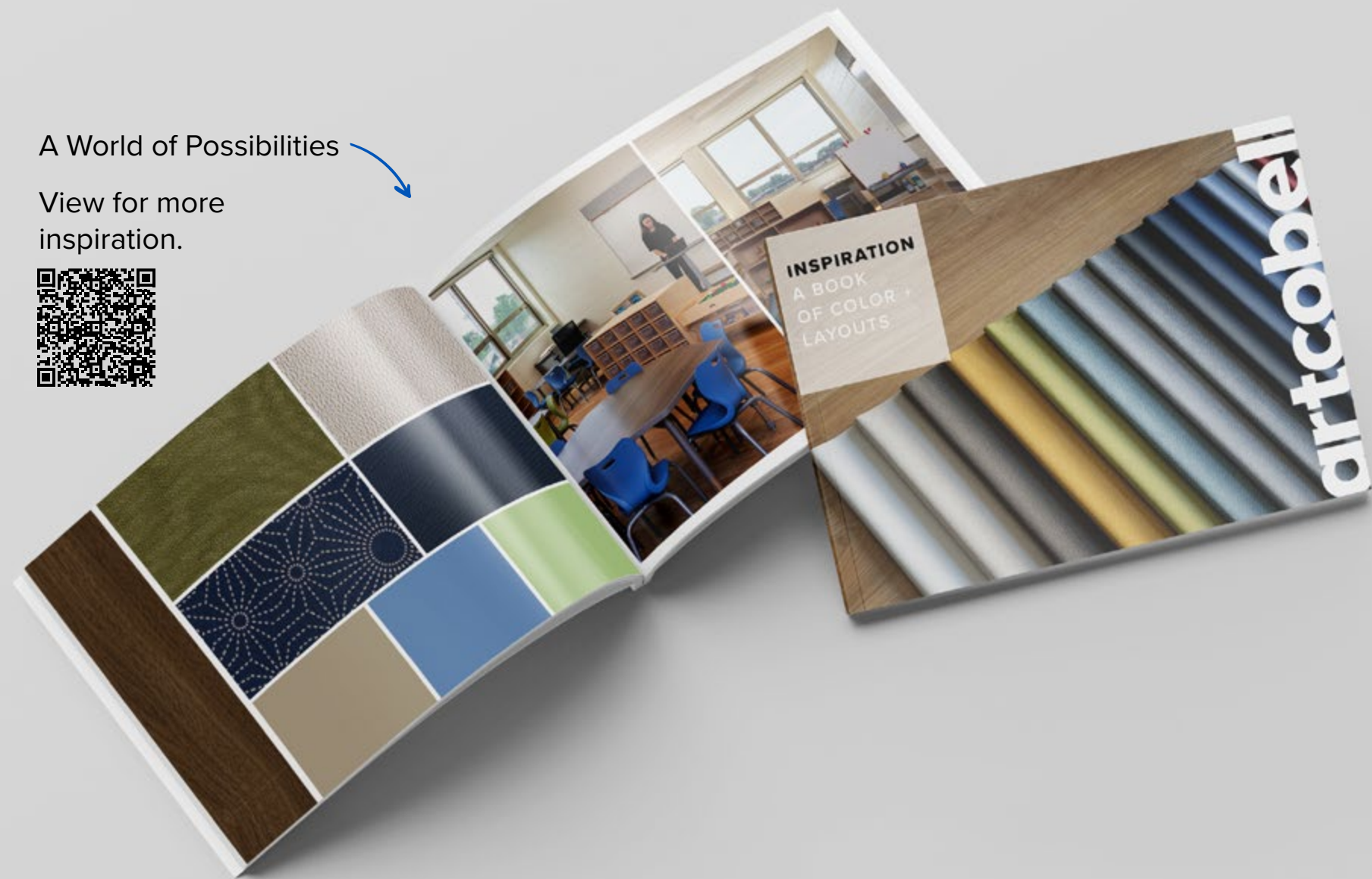

A World of Possibilities
View for more inspiration.



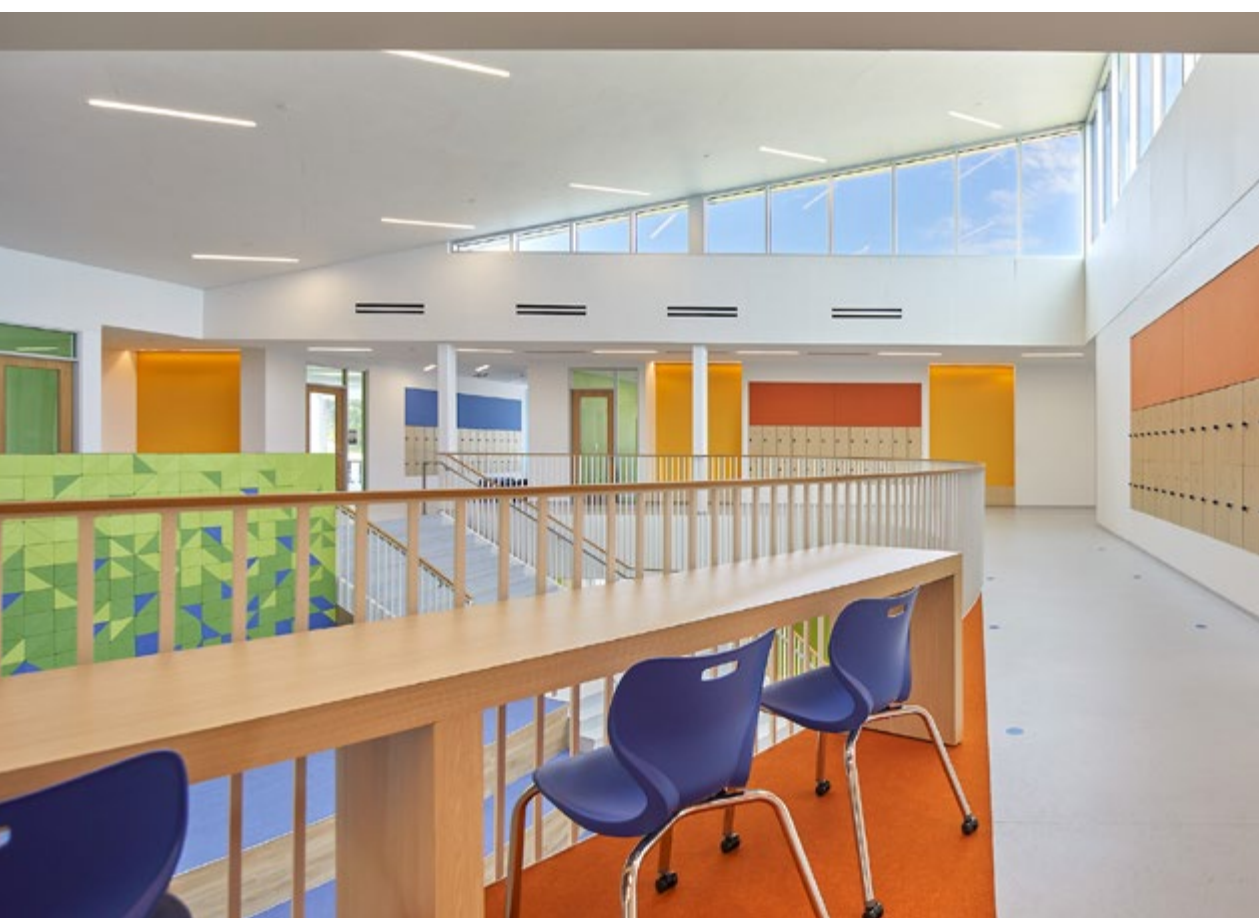
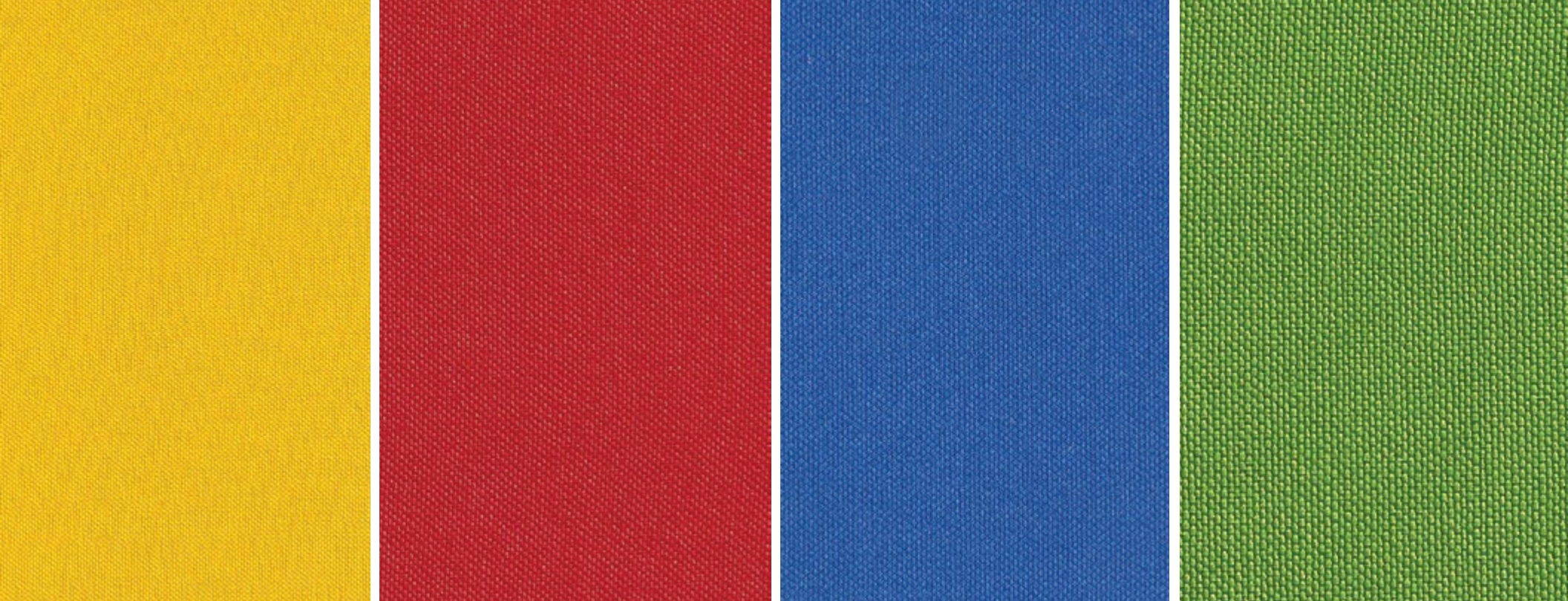

Color Psychology:
For Educational Environments

Plan

Align solutions to your learning strategies. Identify layouts and concepts that address the specific needs of your teaching + learning.

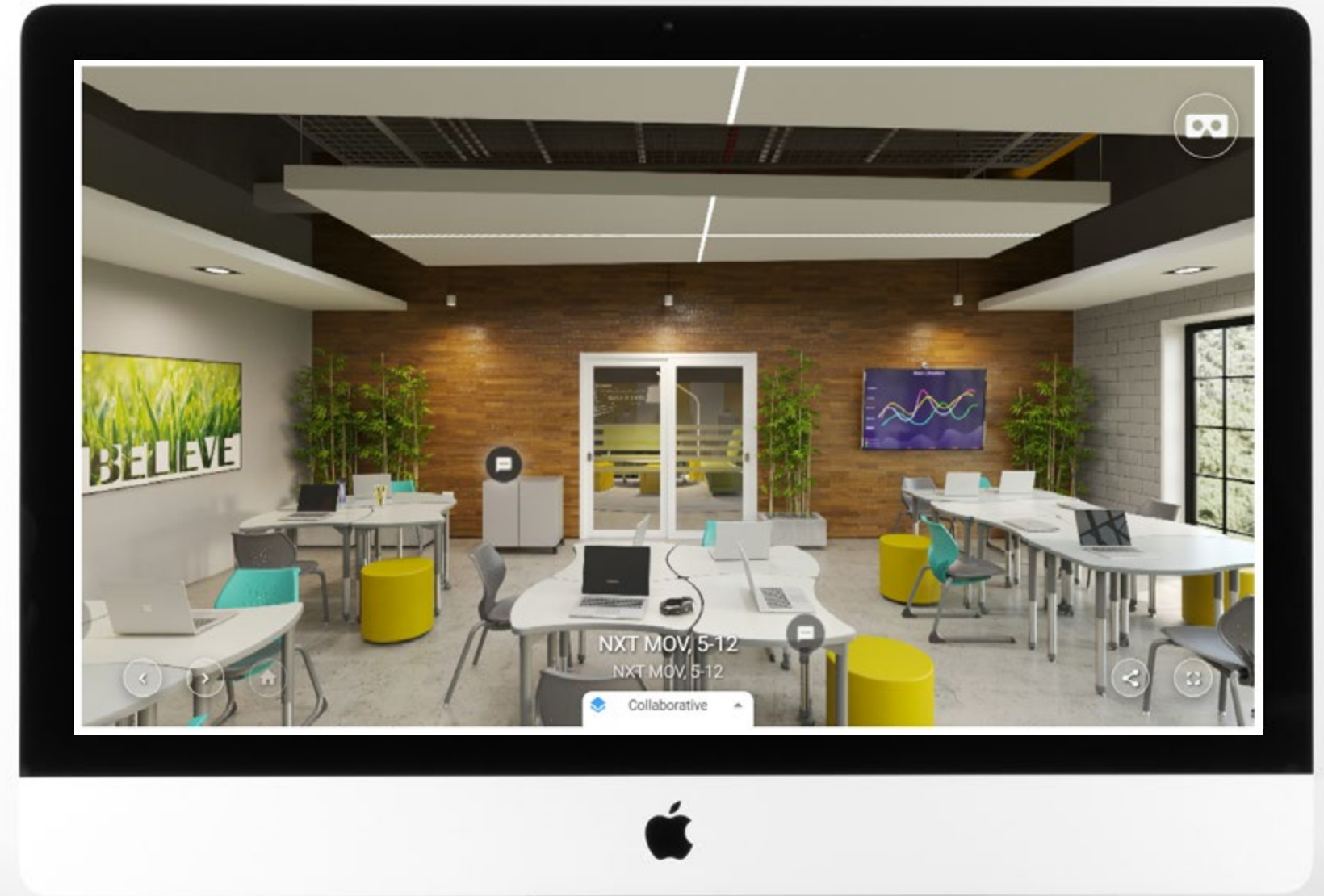

Scan or click to view the NXT MOV® classroom and others in the virtual showroom.

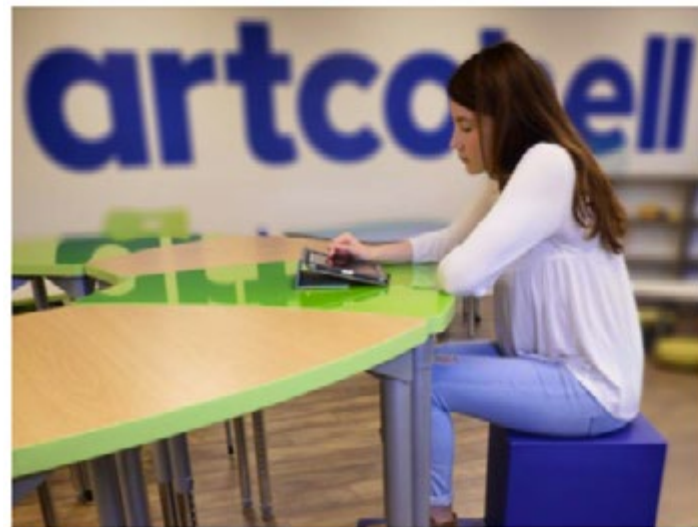

ARTCOBELL'S SOLUTIONS FOR LEARNING SPACES

Can furniture help create an environment that promotes student engagement and impacts student achievement? Artcobell's tenured Learning Environments Leader Patricia Cadigan, M.Ed., offers solutions designed to promote comfort, configurability, mobility, and accessibility in a variety of modern learning environments that are personalized, active, and collaborative. Learn more by exploring these Solutions below.



Maker Space



Classrooms

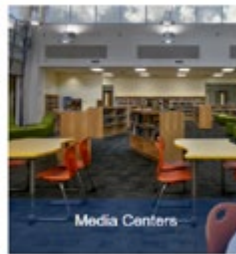

Media Centers



Learning Hallways



Cafe and Cafeterias



Breakout Spaces



Solutions for
learning spaces

Browse the CET planning typicals
gallery, download your favorites,
and insert into your drawings.



THE FUTURE OF CLASSROOM LEARNING ENVIRONMENTS



RECONFIGURE

Convert your **COLLABORATIVE BASED** learning environment where students can defend their ideas to an **INDIVIDUAL BASED** learning environment where they can receive direct instruction and breakout into small groups.

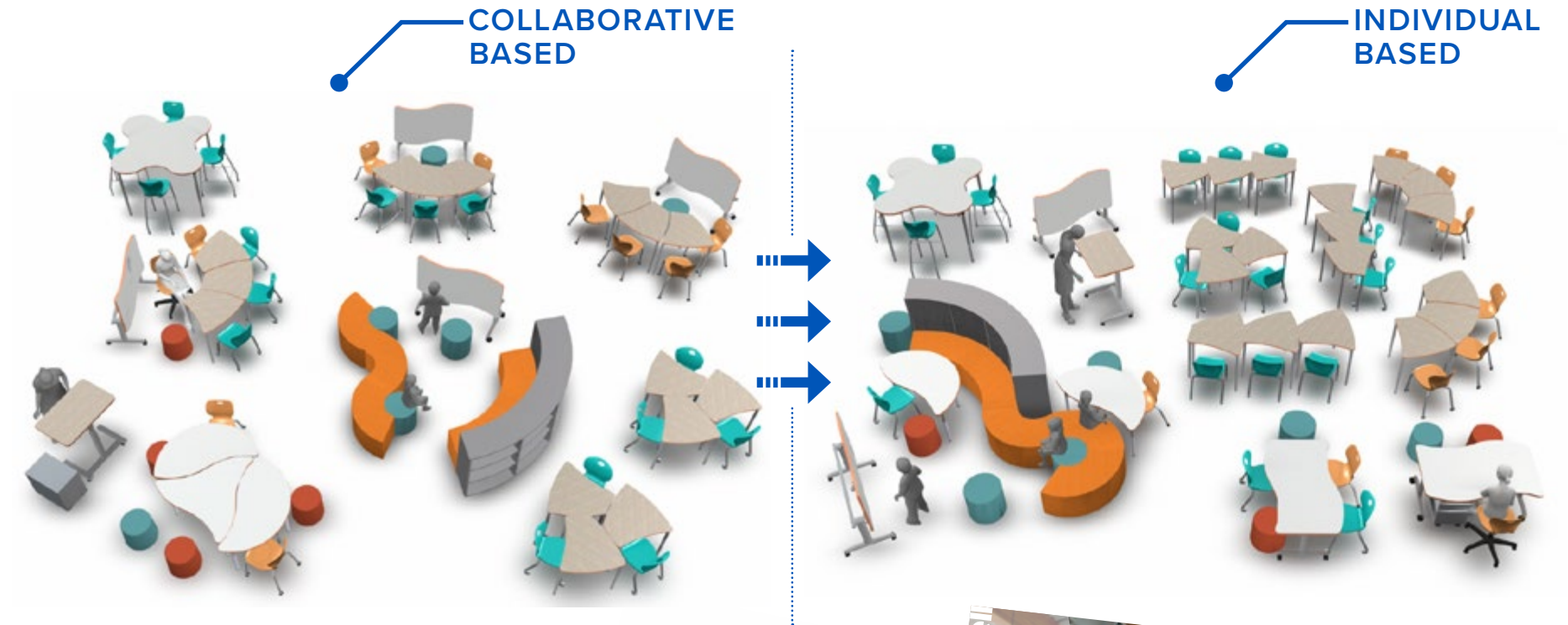

Download the collaborative conversion planning tool kit.

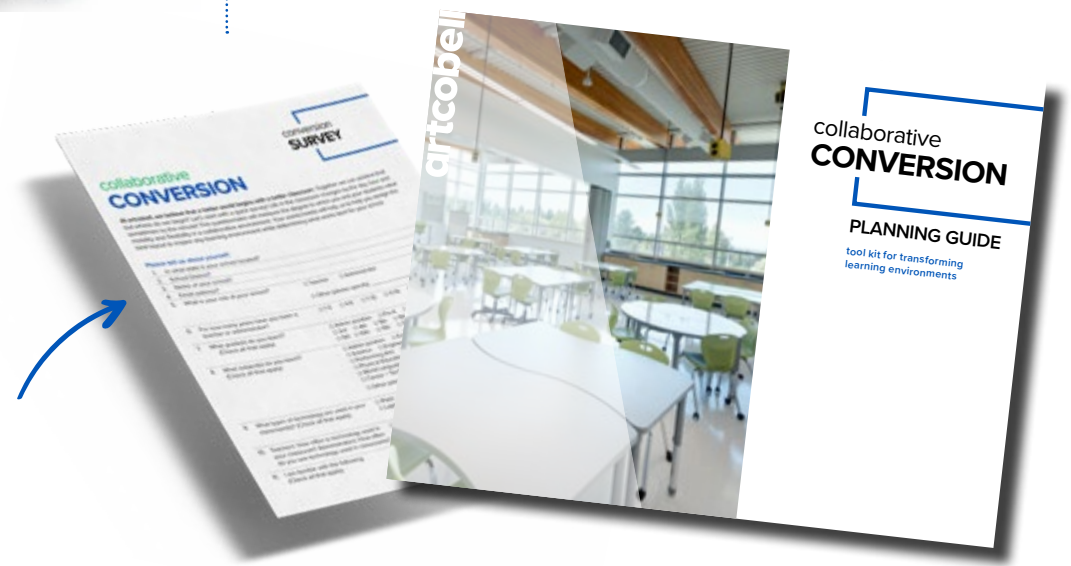

Select

You've wrestled with the why and the what of your transformation. How are you going to do it? Here's where you will identify the specific tools (furniture) to facilitate the change you want.



Scan or click to view the Artcobell product catalog.



Ready to buy?
Connect with an Artcobell
dealer to get started



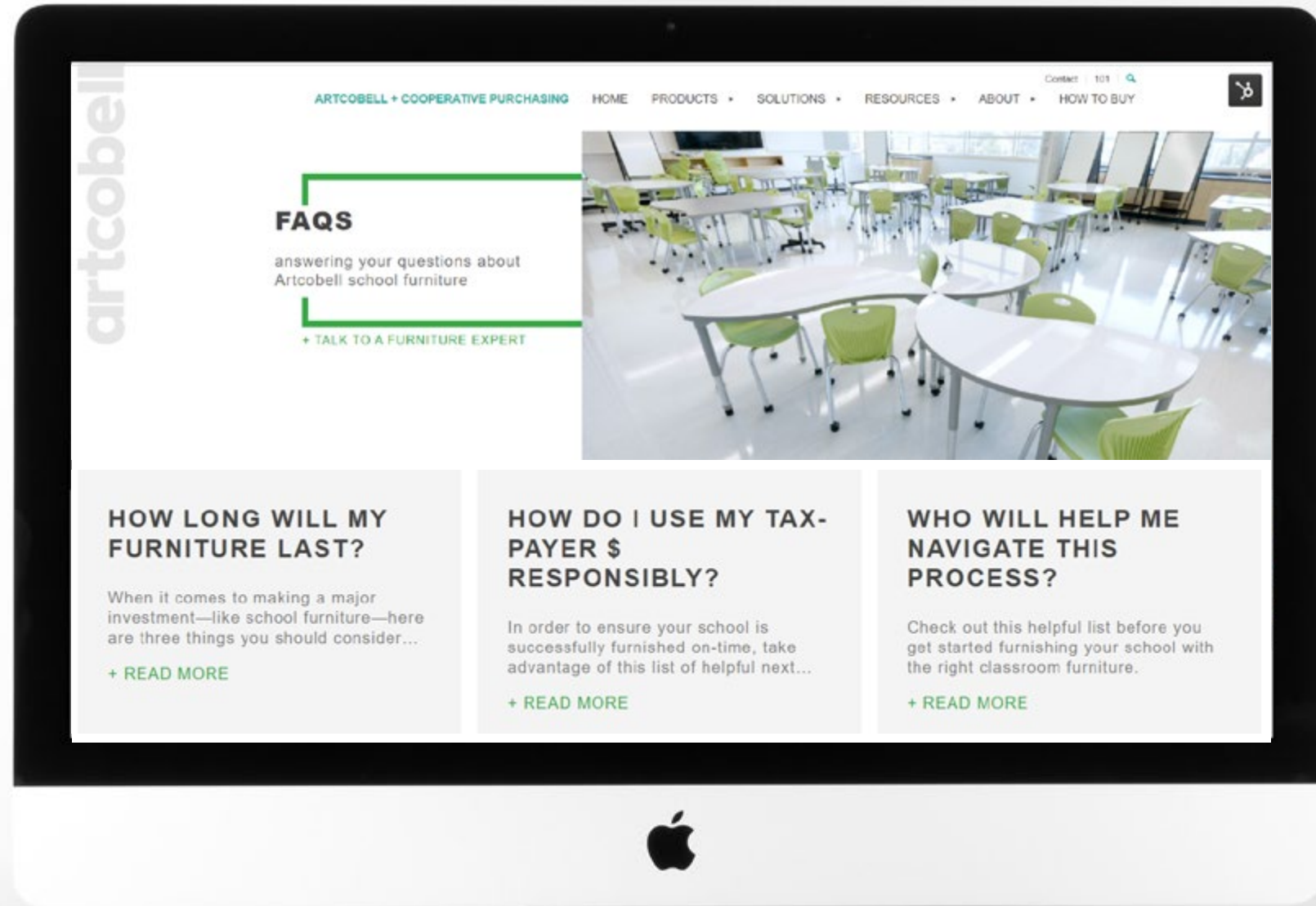

All your questions about Artcobell school furniture answered here!



View configuration guides for our most popular Shape Tables + Desks.





Why is movement so important for student success?

Movement

With the floor height and standing workspaces, padded rockers and FLOT chairs give students the flexibility to sit on the floor, in a chair, or stand. Options are key to student ownership.





Choosing the right
activity table



Flexible and Agile

Large Shape Tables can do double-duty as
workspace and a teaching surface for small
groups, guided instruction, or individual
student conferences.



Flexible seating in schools
and why it's crucial for
classroom setup



Active

Active learning spaces require options. A blend of individual worksurfaces and configurable tables provides flexibility to support a variety of teaching and learning activities.

Collaborative

Collaborative learning environments are settings where learners work together to achieve a common goal. They can take various forms, such as face-to-face or online, synchronous or asynchronous, formal or informal, and structured or unstructured. Collaborative learning environments foster positive interdependence, individual accountability, social skills, and group processing among learners.



How a collaborative classroom enables deeper learning

Personalized

Personalized learning environments are settings that enable students to shape their own learning experiences and outcomes. Creating safe and secure spaces, where they can access resources, tools, and support their needs.

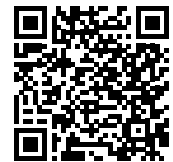

Classroom design layouts that promote student belonging



Multi-Functional

The multi-functional classroom showcases flexible seating, collaborative work surfaces, and mobile furniture that is all designed to work together. Use these to create environments that are safe and secure and provide students with voice and choice – now and in the future.



See how Shape Tables + NXT MOV Student Desks work together to create a learning environment like no other!

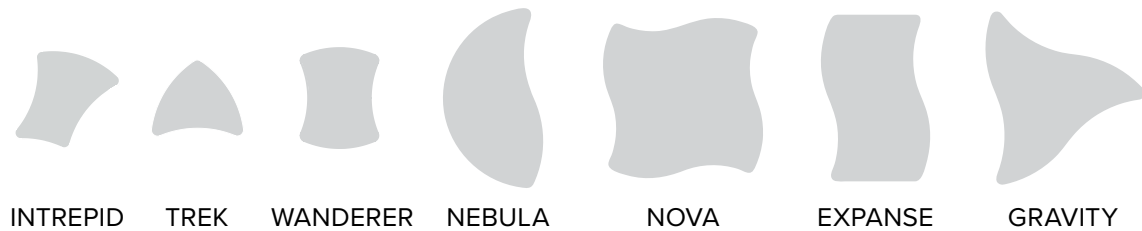

Train

New furniture. Now what?

After the boxes have been cleared away, how will your teachers and students use their new furniture? Transforming spaces also means transforming practices.



Professional learning for schools.
Read on for details about on-demand,
virtual and in-person learning options.





Contact info

www.artcobell.com

© 2024. Unless attributed to others, content is the property of Artcobell and may not be reproduced without permission.

Front and back cover + page 9 by [Corgan](#)